

31711 469TH AVE

<https://cardinalcityrealty.com>

Burbank, SD, 57010



COMM AT PT 30 RDS S OF NE COR NE 1/4 THENC S 16 RDS THENC W 10 RDS
THENC N 16 RD THENC E 10 RDS TO POB 14-92-51 FAIRVIEW TWP

- Multi-Unit
- Pending
- 4752 sq ft

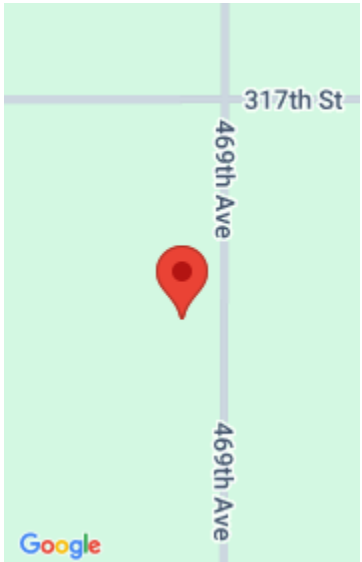

Basics

Category: Multi-Unit

Area: 4752 sq ft

Status: Pending

Year built: 1920

Agent

Agent First Name: Aaron

Agent Email: Aaron.Tyler@kw.com

Agent Last Name: Tyler

Agent Phone Number: 712-253-4139

Building Details

Parking: Attached

