

4545 110TH AVE

<https://cardinalcityrealty.com>

Peterson, IA, 51047

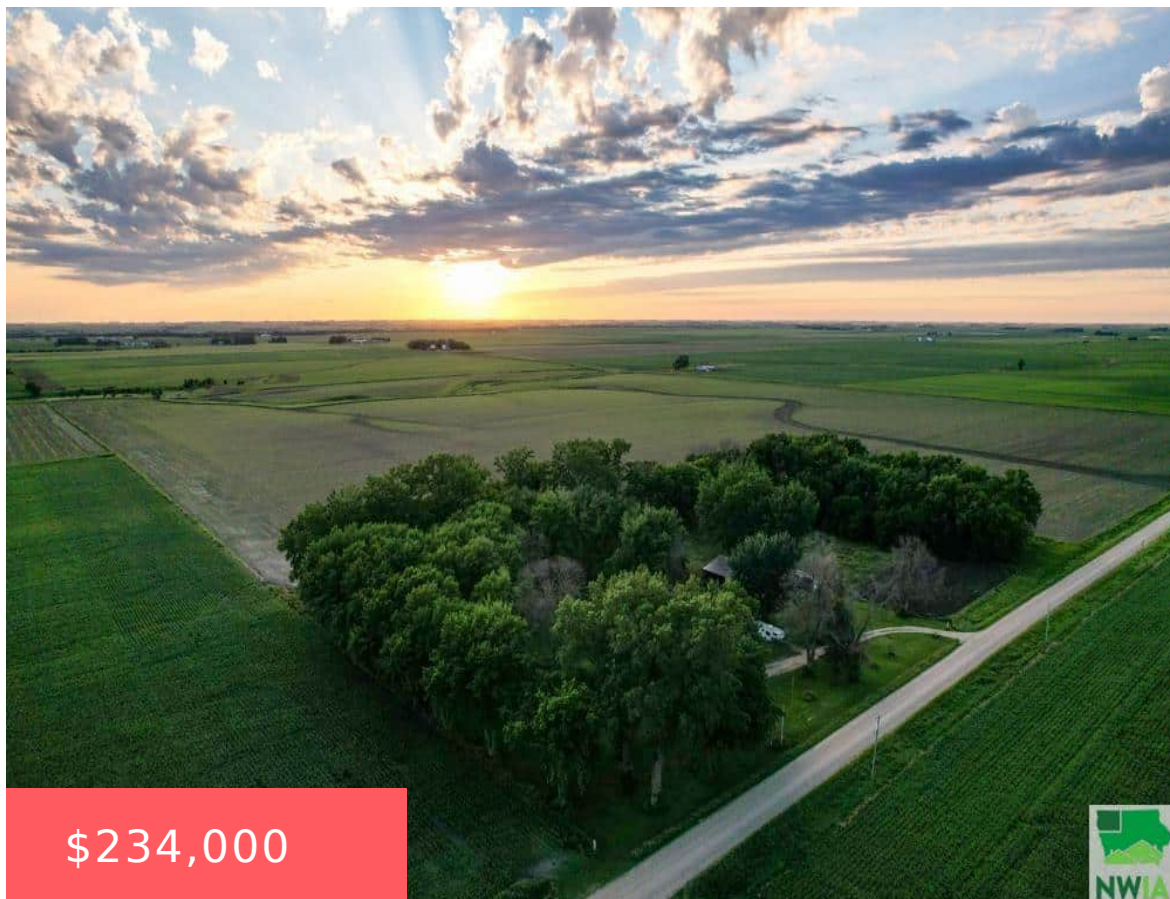

TRACT 444' X 673 SE NE

- 2 beds
- 2 baths
- Split
- Residential
- Pending
- 2016 sq ft

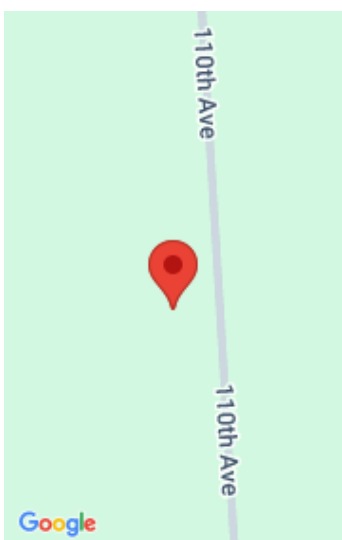

Basics

Category: Residential

Status: Pending

Bathrooms: 2 baths

Area: 2016 sq ft

Type: Split

Bedrooms: 2 beds

Floor level: 1008

Year built: 1978

Agent

Agent First Name: Andrea

Agent Last Name: Larson

Agent Email: alarson@midwestlandgroup.com

Agent Phone Number: 319-572-9260

Building Details

Basement: Finished

Exterior material: Vinyl

Roof: Shingle

Parking: None

